





**CL.1 Llave de paso empotrada cierre a la izquierda caliente 1/2" - Platino cepillado**

CL.1

36 607 707

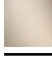

- Roseta 60 x 60 mm
- Con distintivo caliente
- Montura con husillo ajustable y camisa

|   |                               |               |
|---|-------------------------------|---------------|
|  | Platino cepillado             | 36 607 707-06 |
|  | Cromo                         | 36 607 707-00 |
|  | Dark Chrome                   | 36 607 707-19 |
|  | Champagne cepillado (Oro 22k) | 36 607 707-46 |
|  | Champagne (Oro 22k)           | 36 607 707-47 |
|  | Dark Platinum cepillado       | 36 607 707-99 |

**Complementos necesarios**



- Válvula empotrada 1/2" -** 35 607 970 90
- Profundidad de montaje mín. 105 mm
  - Profundidad de montaje máx. 150 mm

CL.1 Llave de paso empotrada cierre a la izquierda caliente 1/2" - Platino  
cepillado

---

CL.1

36 607 707  
mm [inches]

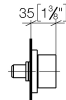
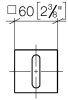

Certificado

---

DVGW\_DW-  
6501DN0116.

IAPMO\_4976 (1).

LGA\_29931.

WRAS\_2010066.

LGA\_29932.

36 607 707

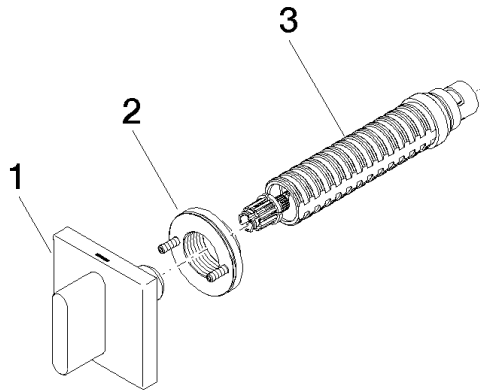

### Lista de piezas de recambios

| N° | Número de artículo | Denominación    | Cantidad de montaje | Plazo de entrega |
|----|--------------------|-----------------|---------------------|------------------|
| 1  | 90 20 70 051 03-06 | manilla ( hot ) | 1                   | 10               |
| 2  | 90 21 02 108 00 90 | disco           | 1                   | 2                |
| 3  | 90 90 03 142 00 90 | parte superior  | 1                   | 2                |